

Paradise Lane, Birmingham, B28 0DT

Offers In Region Of £165,000

2 1 1



Spacious and Well-Presented Two-Bedroom First-Floor Apartment in Paradise Court, Hall Green – No Upward Chain

Key Features

- Spacious First-Floor Apartment
- Modern Fitted Kitchen
- Communal Grounds
- Sought-After Location
- Viewings Highly Recommended
- Bright Living Room
- Two Generous Bedrooms
- Double Glazing
- No Upward Chain
- Ideal Investment Opportunity

FIRST FLOOR
691 sq.ft. (64.2 sq.m.) approx.

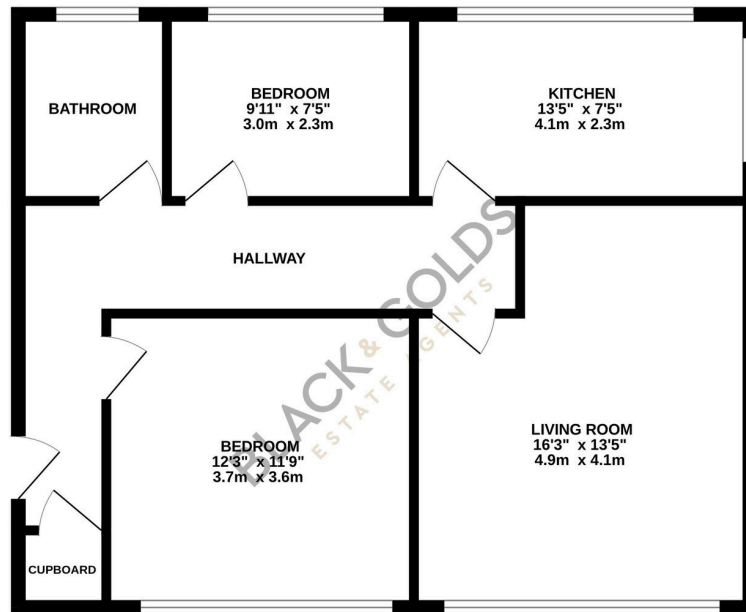

TOTAL FLOOR AREA: 691 sq.ft. (64.2 sq.m.) approx.

Whilst every attempt has been made to ensure the accuracy of the floorplan contained here, measurements of doors, windows, rooms and any other items are approximate and no responsibility is taken for any error, omission or mis-statement. This plan is for illustrative purposes only and should be used as such by any prospective purchaser. The services, systems and appliances shown have not been tested and no guarantee as to their operability or efficiency can be given.
Made with Metropix 6/2024